



Manual de Instrucciones. Pistola



**Modelo : P.GRAV.SC07 HVLP
DEP.600CC**

SPECIFICATION:

■ Fluid orifice.....	<input type="checkbox"/> 1.4MM <input type="checkbox"/> 1.7MM <input type="checkbox"/> 2.0MM
■ Pressure required	15-43psi
■ Air consumption	380Liter/min
■ Material output.....	200-220M/min
■ Compressor required	1HP
■ Air connection.....	1/4" NPS(M)
■ Approx. wt.....	1kg
■ Cup.....	0.6l

COUNTAINS:

• HVLP Spray gun	1 set
• 0.6l Plasjic cup	1 pc
• Tool set	1 set
• Throttle sarainer	1 pc

FEATURES:

- ▲ Fast woking speed and wide fan pattern.
- ▲ High transfer efficiency means redced spray mist.
- ▲ Stainless steel needle and fluid tip allow use with water borne materials.
- ▲ DP6303 spray gun 0.6 litres non-drip plasjic cup.

▲ Significant reduction in operating costs.

Operation:

1.Starting

Prior to any operation, especially after repair work, the seating of screws must be checked and tightened as required. Prior to any repair work the unit must always be disconnected from air pressure circuit.

- Tighten nozzle set Air nozzle must be aligned so that the stamped number is visible straight from to front.
- Air connection R1/4". Prior to fitting, air hose should be blown out.
- Prior to shipment, this gun was treated with an anticorrosive agent. Before using gun make sure that it is carefully flushed with thinner.

2.Adjustment of the jet width

To adjust je width, rotate the stepless adjuster. The spray pattern can be altered from flat to round spray as required.

3.Air quantity control

To set the air to material ratio adjust the stepless air micrometer. While gun is in operation, never dismantle hollow screw for removal of micrometer by hexagon socket screw key.

4.Exchange of nozzle set

When changing to another nozzle, make sure that the complete nozzle set is exchanged. A set comprises air cap, paint nee-

die and paint nozzle. Insert paint nozzle before putting in paint needle.

5. Exchange of the self tensioning sealings

The needle seal is effected by a Teflon seal and a needle packing with self-tensioning compression spring. To change the packing please use the socket spanner provided.

6. Cleaning and gun care

- a) Flush gun thoroughly with solvent.
- b) Clean air nozzle cap with brush. Do not place the gun into solvent.
- c) Clogged holes should never be cleaned with improper objects, the smallest amount of damage badly influences the spray pattern.
- d) Slightly oil movable parts.

Important:

- e) Never dismount the air connection (integrated air converter) could be destroyed.

7. Internal nozzle pressure

- a) At an entrance pressure of 43 psi and more at the air inlet, the internal nozzle pressure exceeds 10 psi.

- b) The Best Fine Atomization At 20-30 Psi

Trouble

- 1. Gun leaks from fluid nozzle
- 2. Paint emerges from fluid needle-needle sealing
- 3. Spray pattern in sickle shape.

- 4. Drop-like or oval shaped pattern

- 5. Paint spray flutters

- 6. Material bubbles or "boils" in paint cup

Cause

- 1. Foreign substances between fluid nozzle and fluid needle prevent sealing.
- 2. Self tensioning needle sealing damaged or lost
- 3. Horn air holes or air circuit clogged
- 4. Dirt on fluid needle tip or air outlet
- 5. Too little material in cup, fluid nozzle not tight, needle sealing damaged, nozzle set dirty or damaged
- 6. Atomization air flows through the paint channel to the cup- The paint nozzle is not tight enough. Air nozzle is not completely screwed, the air net clogged and the seat is defective or nozzle insert is damaged.

Repair

- 1. Clean fluid needle and fluid nozzle in thinner or use new fluid nozzle
- 2. Replace needle sealing
- 3. Soak in thinner, afterwards clean with nozzle-cleaning needle
- 4. Turn air nozzle by 180 degrees. If defective pattern remains, clean paint outlet in air nozzle.
- 5. Refill material, tighten parts, if necessary clean or replace parts.
- 6. Tighten parts accordingly, clean or replace.

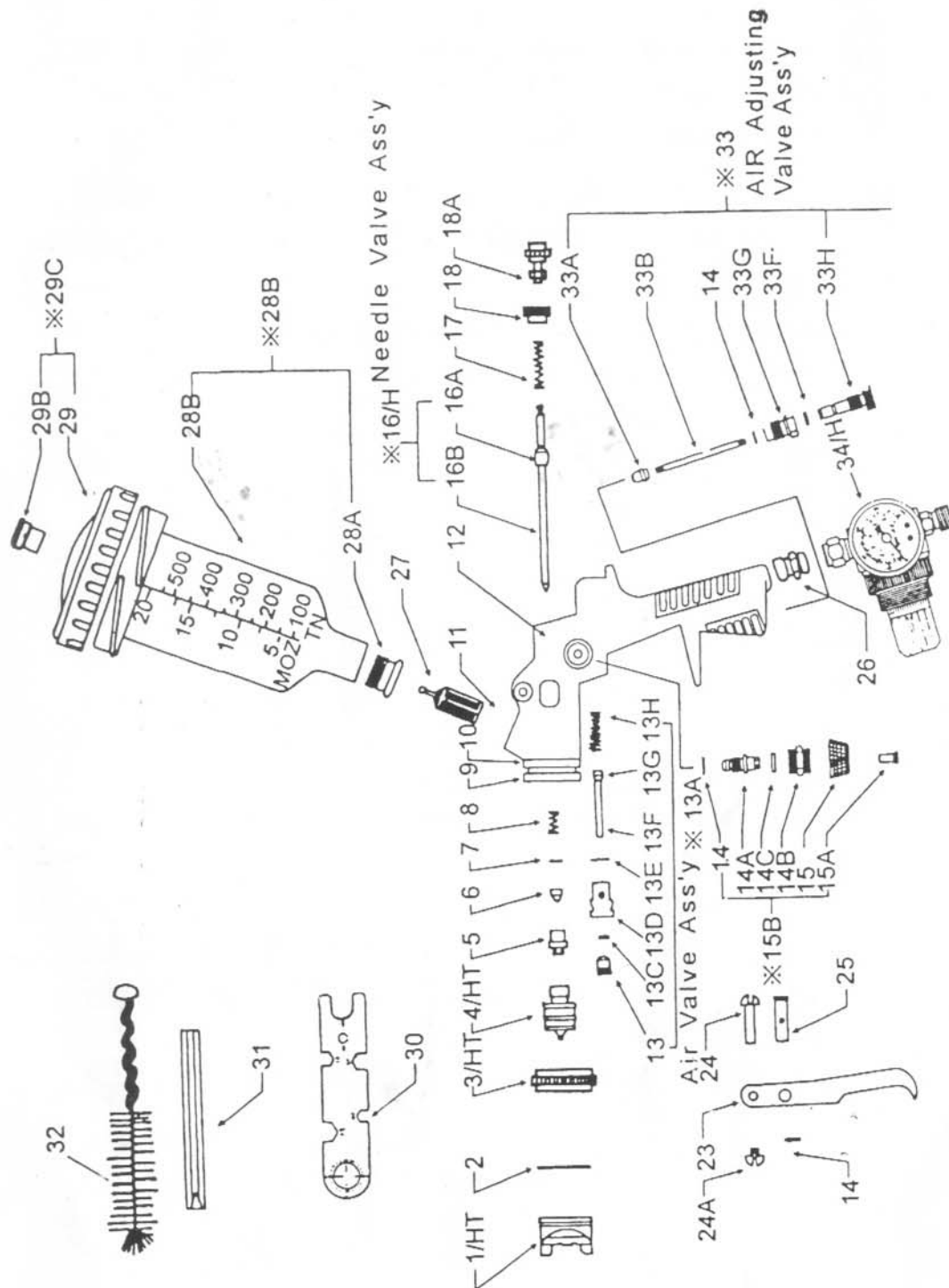

PARTS LIST

Item No.	Description	Item No.	Description
1/HT	Air Nozzle/HVLP	27	015028-0600 FILTRO MATERIAL SC07
2	015025-0600 ARANDELA SC07	28	Plastic Cup
3/HT	015018-0600 ARANDELA DISTRIB. AIRE SC07	28A	015029-0600 ADAPTADOR DEP. GRAVEDAD
4/HT	015026-0600 BOQ. COLOR SC07	29	015030-0600 DEP. COM. SC07
5	015022-0600 TUERCA RETEN DE COLOR SC07	29B	Non-drip Control Device
6	015023-0600 RETEN DE COLOR SC07	30	Spanner
7	015024-0600 MUELLE RETEN DE COLOR	31	Socket Spanner
8	015019-0600 JUNTA CABEZAL	32	Brush
10	015066-0600 JUNTA	33A+B	Air Piston
11	Connector for U. 6/2 cup	33F	Teflon Seal
12	Gun Body	33G	Nut
13	Screw	33H	Screw
13C	Teflon seal	34/H	Air Regulator
13D	Body		
13E	P.C.seal		
13F	Valve		
13G	Valve		
13H	Spring		
14	Washer		
14A	Sparay Regulating Screw		
14B	Sparay Regulating Nut		
14C	O-Ring		
15	Control Knob		
15A	Countersunk Screw		
16	Paint Needle-Complete/HVLP		
17	015078-0600 MUELLE AGUJA COLOR SC07		
18	015077-0600 REG. COLOR SC07		
18A			
23	Trigger		
24	Screw		
25	Pin		
26	Air Connection Piece 1/4" BSP/HVLP		

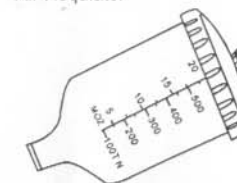

Spare Cup(Complete set)

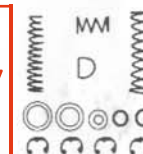

Repair kit for spray gun
PARTS NO:06 07 08 13C 13E
13H 14C 14x4PC 33F 17



015015-0614 JUEGO COMPLETO SC07 (P-1,40)
015015-0617 JUEGO COMPLETO SC07 (P-1,70)
015015-0625 JUEGO COMPLETO SC07 (P-2,50)

Have to order complete set if special mark "*" !

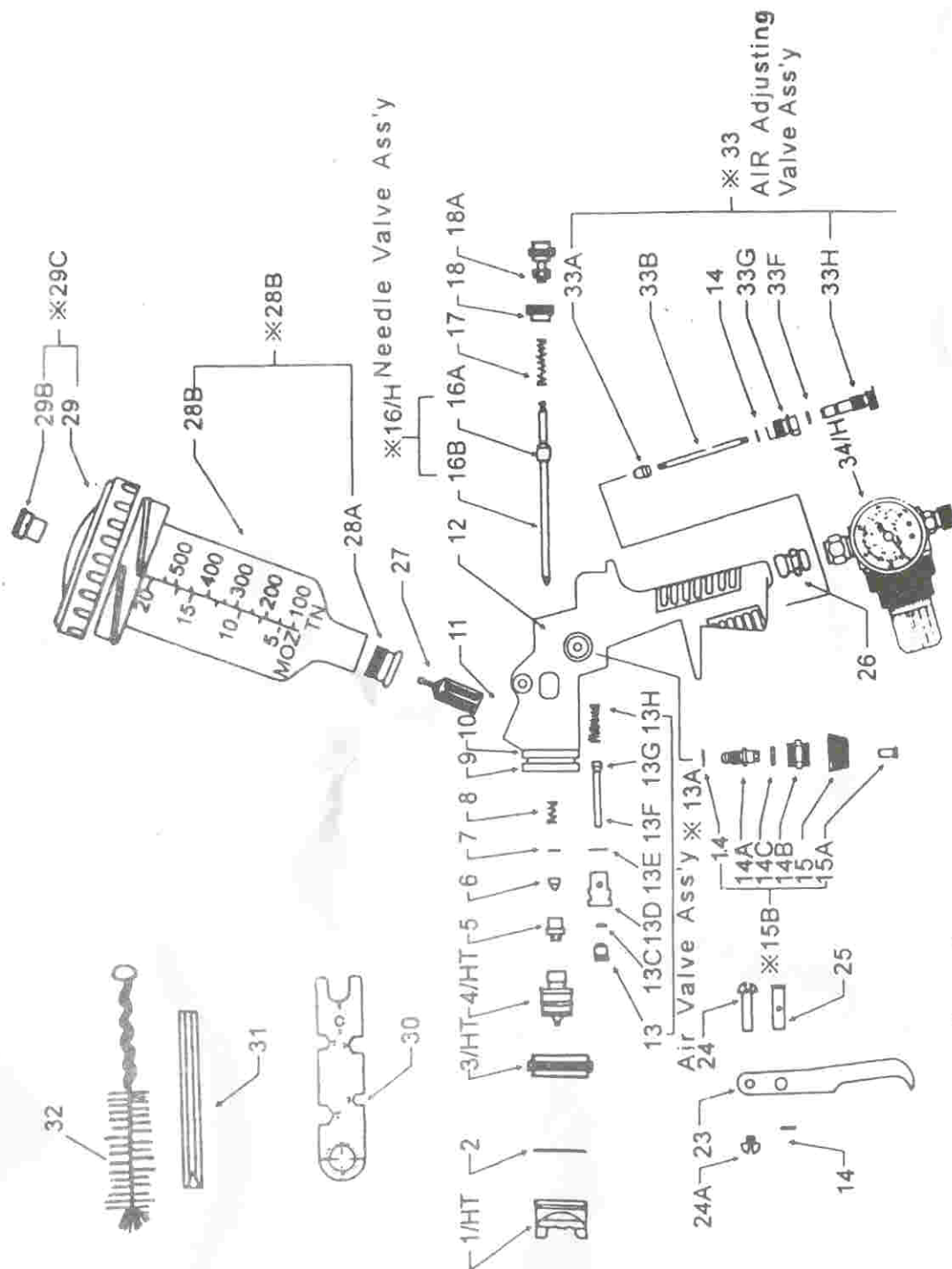

PARTS LIST

Item No.	Description	Item No.	Description
1/HT	Air Nozzle/HVLP	27	Material Sleeve
2	Ring	28	Plastic Cup
3/HT	Air Cap/HVLP	28A	Adaptor
4/HT	Fluid Nozzle/HVLP	29	Cover of 0.6 l Plastic Cup
5	Pacing screw for paint Needle	29B	Non-drip Control Device
6	Taflon Seat	30	Spanner
7	Washer	31	Socket Spanner
8	Spring	32	Brush
9	Brass Ring(TO open clockwise)	33A+B	Air Piston
10	Gasket	33F	Teflon Seal
11	Connector for 0.6l cup	33G	Nut
12	Gun Body	33H	Screw
13	Screw	34/H	Air Regulator
13C	Teflon seal		
13D	Body		
13E	P.C.seal		
13F	Valve		
13G	Valve		
13H	Spring		
14	Washer		
14A	Sparay Regulating Screw		
14B	Sparay Regulating Nut		
14C	O-Ring		
15	Control Knob		
15A	Countersunk Screw		
16	Paint Needle-Complete/HVLP		
17	Spring for Paint Needle		
18	Lockout for Fluid Control Knob		
18A	Fluid Control Knob		
23	Trigger		
24	Screw		
25	Pin		
26	Air Connection Piece 1/4" BSP/HVLP		

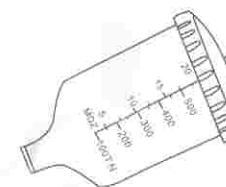

Spare Cup(Complete set)

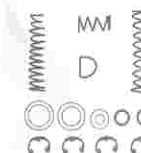

Repair kit for spray gun
PARTS NO:06 07 08 13C 13E
13H 14C 14×4PC 33F 17



Nozzle set(1.4mm 1.7mm 2.0mm)

Have to order complete set if special mark "※"